

IT	NAME	MATERIAL	REMARK
1	CORD	SJT 3X14AWG	φ9.7
2	BODY	PVC(95°)	
3	CONTACT BLADE	C2680RC-1/2H MBNI	A-323
4	EARTH PIN	C2680RC-1/2H MBNI	A-267A

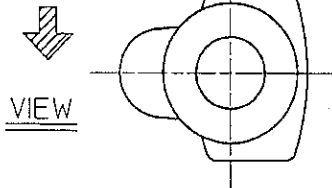
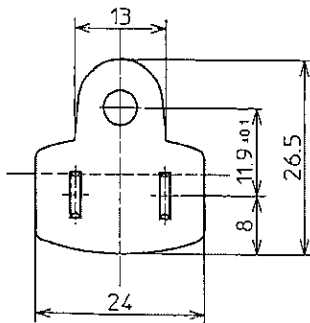
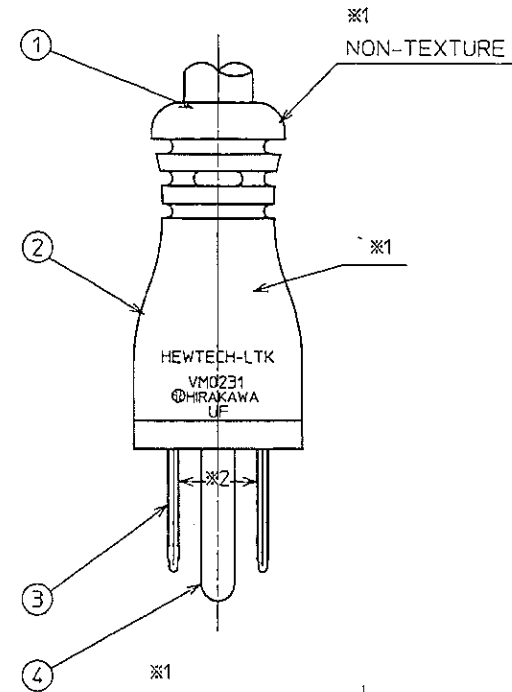
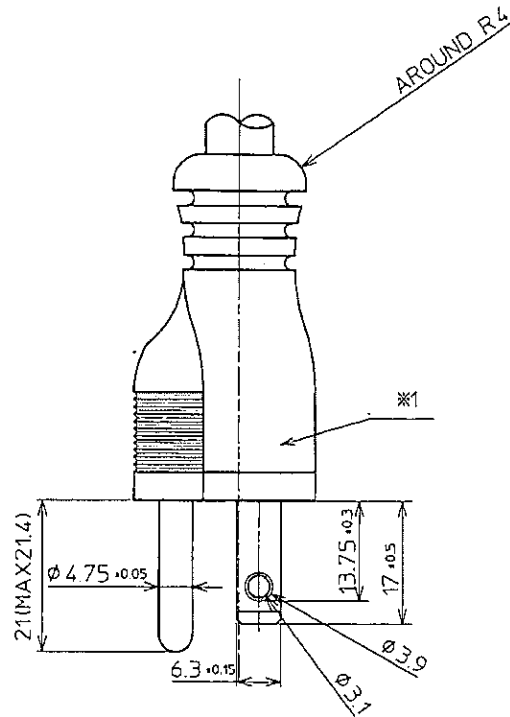
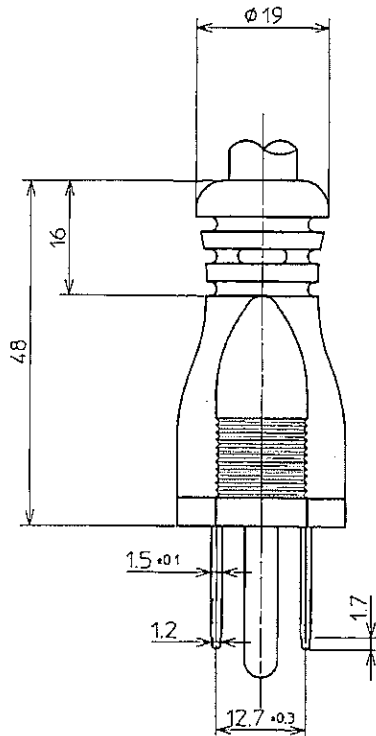

NOTE

※1. TEXTURE SNA2 (TANAZAWA)

※2. Markings on the blades (inside blades)

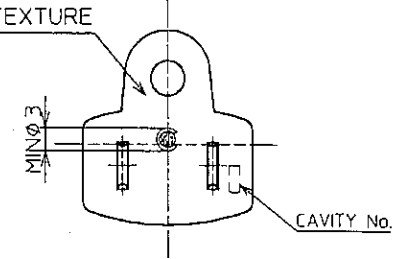

LET	REVISION	DATE	SIGN
△X			
△X			
△X			
△X			



TOLERANCE		ANGLE	SCALE	UNIT	NAME
DIMENSION	TOL.	DR. T. Aizawa	1.5 : 1	mm	3P-PLUG
L ≤ 63	±0.5	CH. I. Igayashi			PART NO. VM02310-AA
		APP. T. Katsu			DRAWING NO. MC0083CA

DATE	NAME
July 9'98	T. Aizawa
July 9'98	I. Igayashi
July 9'98	T. Katsu

IT	NAME	MATERIAL	REMARK
1	INNER BASE	#66NYLON	C-485A
2	CONTACT SLEEVE	C519RC-1/2H 1-0.6	B-202A
3	BODY	PVC(05')	
4	CORD	SJT 3X14AWG	φ9.7

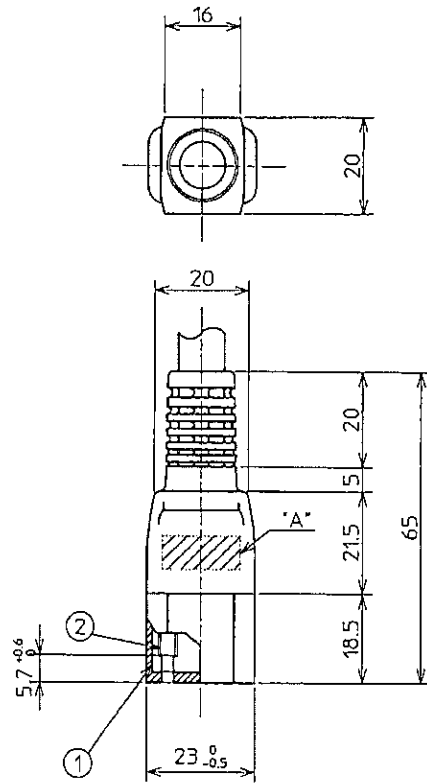

MARKING OF AREA 'A'

WM0293  
 © HIRAKAWA  
 UF

MARKING OF  
 THE REVERSE SIDE AREA 'A'

15A-125V  
 HEWTECH-LTK

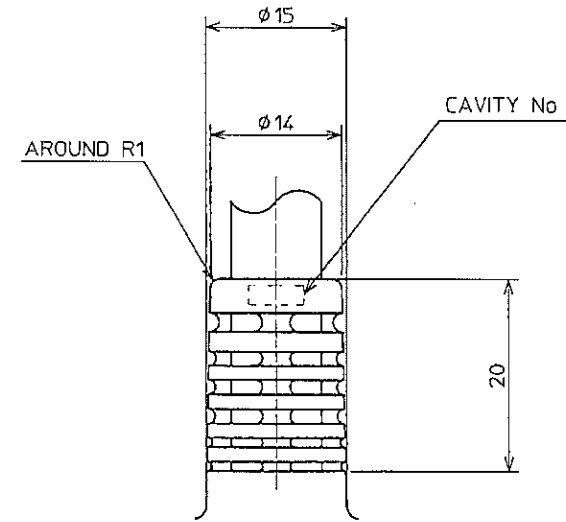
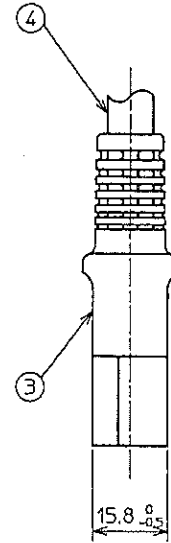

DETAIL OF STRAIN RELIEF

2/1

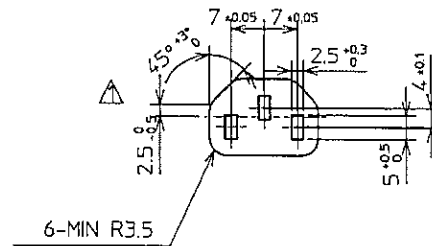
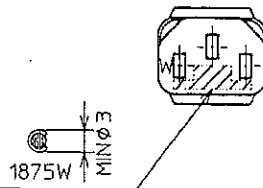

△×				 HIRAKAWA HEWTECH CORP.	TOLERANCE	ANGLE	SCALE 1:1	UNIT mm	NAME UL CSA 15A 125V 3P-CONNECTOR
△×					DIMENSION	DR. T.AIZAWA	DATE Mar. 9'98		PART NO. VM02930-B0
△×					L ≤ 4 ±0.2	CH. I.IGARASHI	DATE Mar. 9'98		DRAWING NO. MC0016CB
△× 1	変更	Sep.16'98	T.KATSU		4 < L ≤ 16 ±0.3	APP. T.KATSU	DATE Mar. 9'98		
LET	REVISION	DATE	SIGN	16 < L ≤ 63 ±0.4					
				63 < L ±0.5					